

Gourmet

by par **Starfrit**

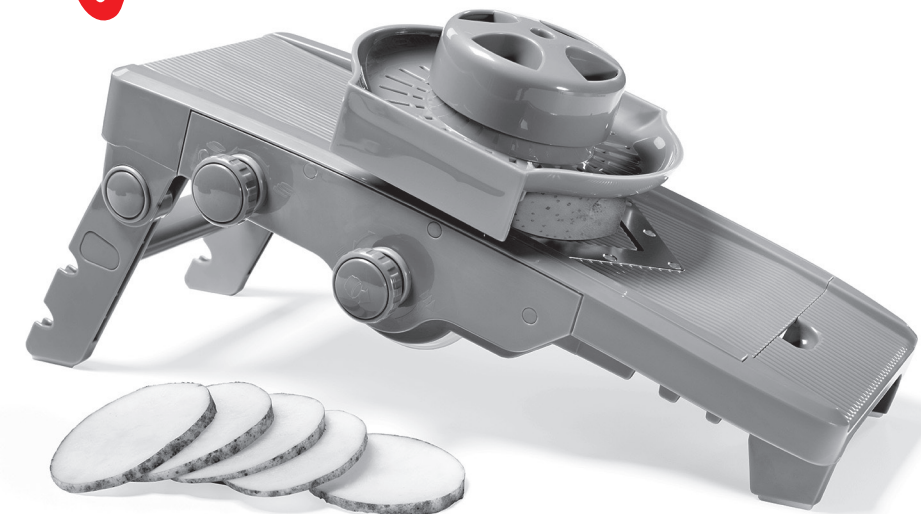

Instructions

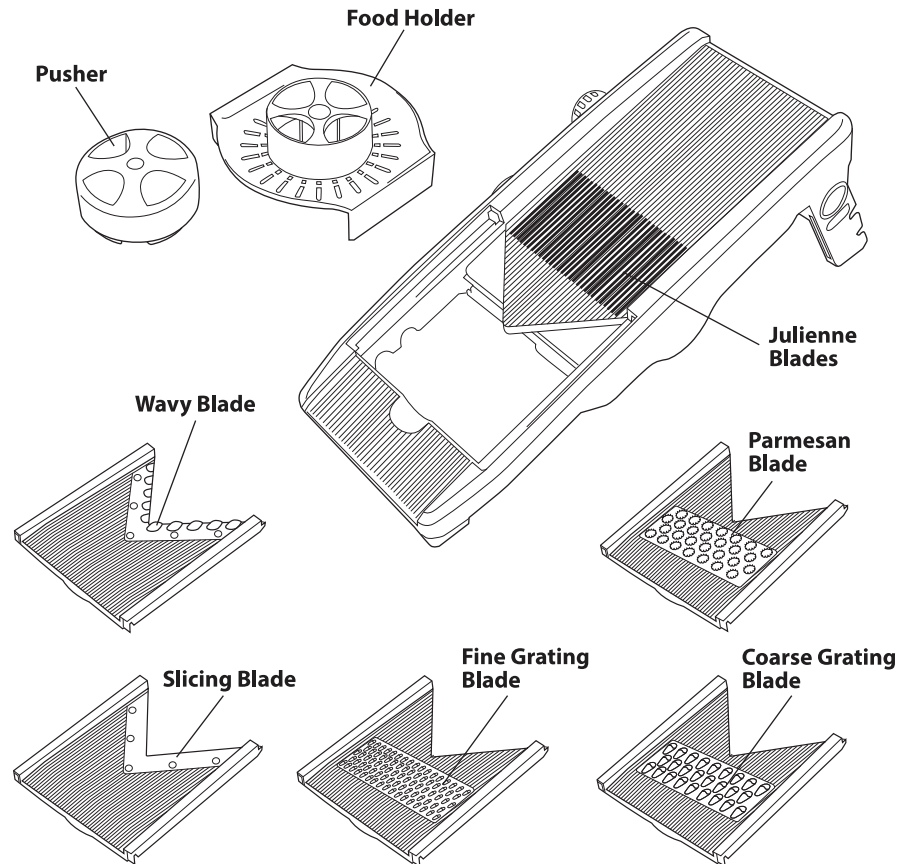

HOW TO USE

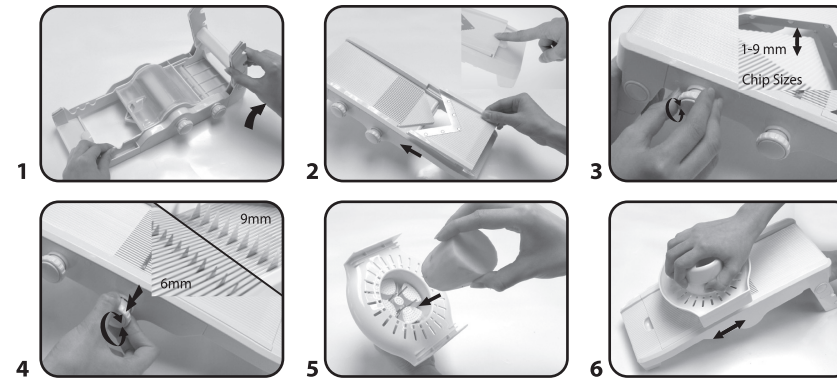

1. Unfold the stand and place the mandoline on flat surface.
2. Insert chosen blade and press to lock it correctly in place.
3. To adjust thickness of the slices, turn upper knob to desire thickness.
Turn clockwise to increase thickness and counterclockwise to reduce thickness.
4. For julienne blades, pull lower knob to raise the blades.
Turn right to adjust to 6mm or 9mm juliennes.
5. ALWAYS USE PUSHER AND FOOD HOLDER GUARD WHEN IN USE.
Fix food to the pins of the food holder.
6. Hold stand and push food holder forwards to slice.

TO USE ON A BOWL



Fold stand and place the mandoline over a bowl/container. Make sure to fit the notches underneath to assure security.

CLEANING

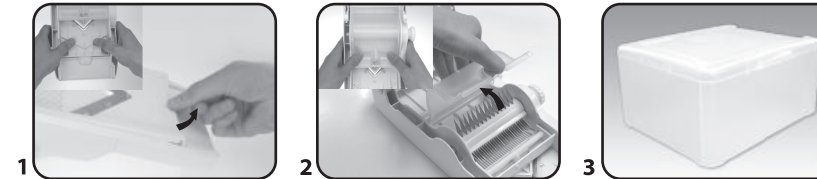

Always wash before first use.

All pieces are top rack dishwasher safe, except blade casing is hand wash only.

1. To clean the blades, lift the blade or push underneath to remove from mandoline.
2. To clean the julienne blades, underneath the mandoline you will find a blade cover. Lift the cover and remove from mandoline. Once clean, place back by pressing the cover back in appropriate place.
3. For safety storage, always store the blades in the blade casing.

WARNING

Always use pusher and food holder when in use.
Always store blades in blade casing.

WARNING
SHARP BLADES
Be careful when using
and washing this item
to avoid injury.

Starfrit.com



SUBSCRIBE TO THE NEWSLETTER TO LEARN MORE ABOUT OUR PROMOTIONS!

PRINTED IN CHINA FOR: ATLANTIC PROMOTIONS INC. LONGUEUIL (QUÉBEC) J4G 1V6
CUSTOMER SERVICE: STARFRIT.COM/EN/CONTACT-US