

Starfrit

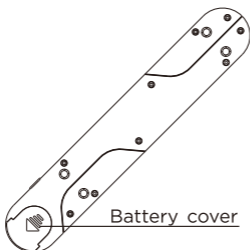

**ELECTRONIC KITCHEN SCALE
BALANCE DE CUISINE ÉLECTRONIQUE
BALANZA DE COCINA ELECTRÓNICA**

PRODUCT DEMONSTRATION

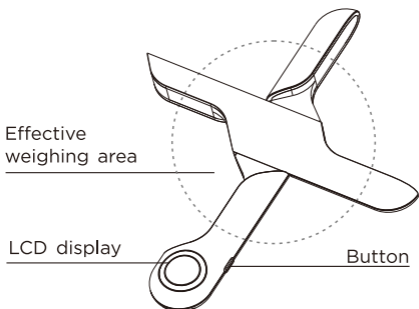

LCD

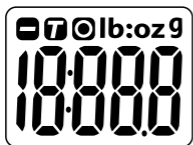

- Tare weight
- Negative value
- Zero weight
- g** Gram
- lb:oz** Pound: Ounce

TO INSTALL OR REPLACE BATTERY

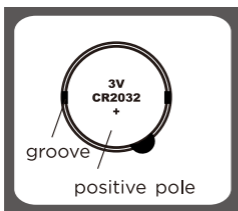

One 3V CR2032 lithium battery(included)

1. Please switch the battery case according to the indication mark, push the battery gently, then it will pop out (please use a tool if necessary).
2. Install the battery with positive plate on top.
3. To install the battery cover, aim rightly at the groove, then switch the battery case reversely.

OPERATION

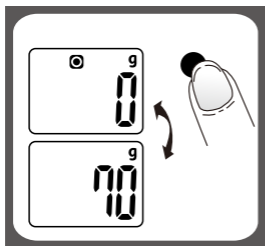

1. Put the scale on a flat platform, spread in a 90° angle'
2. Put the plate on the scale (if necessary);
3. Push"  "button to turn on the scale.
4. Start weighing when it shows "zero";
5. Put the object on the scale, then lcd shows the weight.

"ZERO" OR "TARE" FUNCTION

To weigh different loads consecutively without removing loads from the scale. Put first load on the scale, get weight reading. Press "⏻" button to reset the LCD reading to "0" before adding next load. You can repeat this operation.

CONDITION 1: "ZERO" FUNCTION

When total sum of all loads on scale $\leq 4\%$ of scale's max.weight capacity.

($4\%=80\text{g}$ when capacity is 2000g ; 200g when capacity is 5000g)

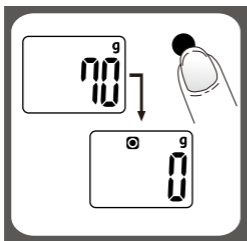

CONDITION 2: "TARE" FUNCTION

When total sum of all loads on scale > 4% of scale's max.weight capacity.

(4%=80g when capacity is 2000g; 200g when capacity is 5000g)

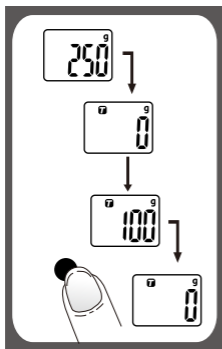

TO CONVERT WEIGHT UNIT

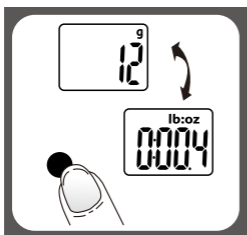

If the scale is with both unit system of Metric(g, ml) or Imperial (lb:oz, fl'oz), press "  " button for five seconds to convert units.

AUTO SHUT OFF

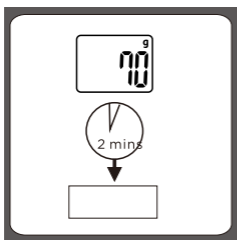

Auto shut-off occurs if display shows "0" or shows the same weight reading for about 2 minutes.

Attention: the product doesn't have the manual turn off function.

WARNING INDICATORS

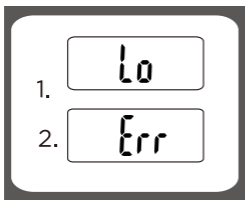

1. When the LCD shows "Lo", indicating low battery, please replace new battery.
2. When the LCS shows " Err", indicating overload.Please remove item to avoid damage.(Max. weight capacity is indicated on the scale)

CLEANING AND CARE

1. Clean the scale with a slightly damp cloth. Do not immerse the scale in water or use chemical/abrasive cleaning agents.
2. All plastic parts should be cleaned immediately after contact with fats, spices, vinegar and strongly flavored/colored foods. Avoid contact with acids citrus juices.
3. Always use the scale on a hard, flat surface.
4. DO NOT strike, shake or drop the scale.
5. Treat the scale with care since it is a precise instrument.
6. Put the scale in a cool and dry place.
7. For family use only. DO NOT use for commercial purpose.